

SO-160-PCB

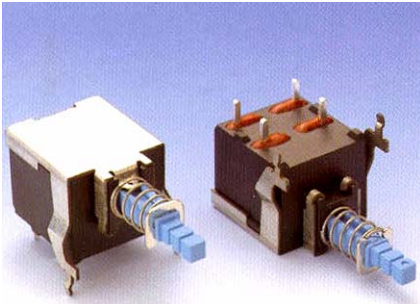

Rating: 10A 250V AC TV-8

Approvals: UL/CSA

Dimensions:

ELECTRICAL : CONTACT RESISTANCE : 30mΩ MAX
 DIELECTRIC VOLTAGE :
 AC 1,000V FOR ONE MINUTE
 LEAKAGE RESISTANCE : 500 Meg Ω MIN
 RATING : TV-8 10A250V~
 LAMP : LIFE-TIME :TV-8 25,000 CYCLES MIN

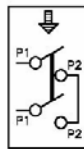

SCHEMATIC DIAGRAM

NOTES :

1. OPERATING FORCE 500±200 gf
2. IF FRAME WAS CUT BY SHEAR FOR THE CUTTING SECTION MAY GATHERED RUST

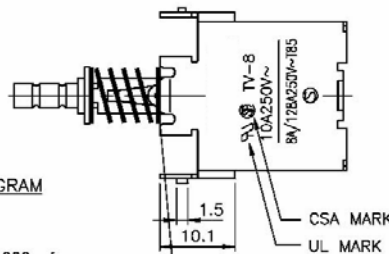

NO.	PART NAME	DESCRIPTION
1	CASE	PHENOLIC
2	ROD	PBT 420-SLO (WHITE)
3	FRAME	STEEL, CHROMATE Nickel PLATED
4	TERMINAL	COPPER ALLOY,
5	TERMINAL	SILVER PLATED
6	BLADE	COPPER ALLOY,
7	BLADE	SILVER PLATED
8	SPRING	PHOSPHOROUS BRONZE
9	STOPPER	PIANO WIRE
10	SPRING	STAINLESS STEEL
11	SPRING HOLDER	GALVANIZED SHEET
12	CONTACT	PLATING SILVER ALLOY t=0.3 mm
13	CONTACT	PLATING SILVER ALLOY t=0.3 mm

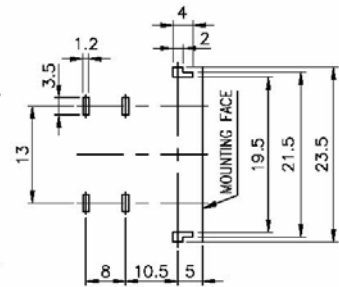
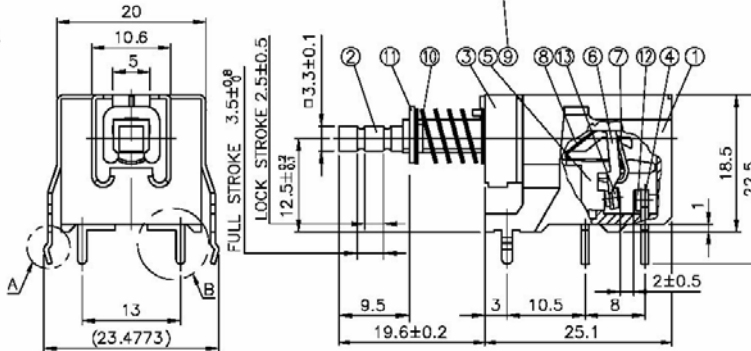
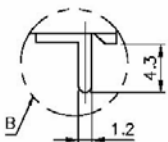
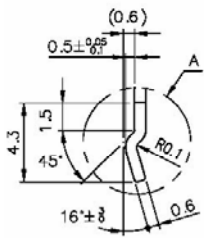

P.C. BOARD MOUNTING HOLD DIMENSION